

# BROOKLYN

## Clean Energy Hub

Offshore Wind Capacity:

**1,500MW OSW**

**Expandable to 6,000MW**

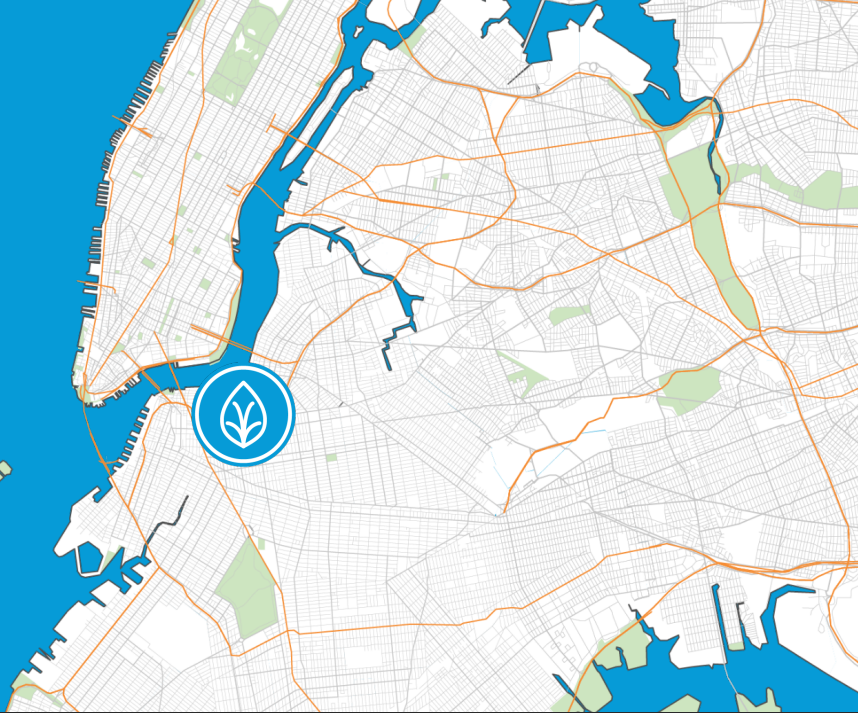

The Brooklyn Clean Energy Hub at Hudson Avenue reuses an existing large property owned by Con Edison. Electrically located to accommodate up to 6,000MW of incremental clean energy generation with minimal system modifications.

**Location:** Hudson Ave, Brooklyn

**Property:** 3 acres; zoned Manufacturing

**Transmission Connections:**

- Load Support: ~1,900 MW
- Interconnection to three other transmission substations

**Injection:** up to 6,000 MW injection

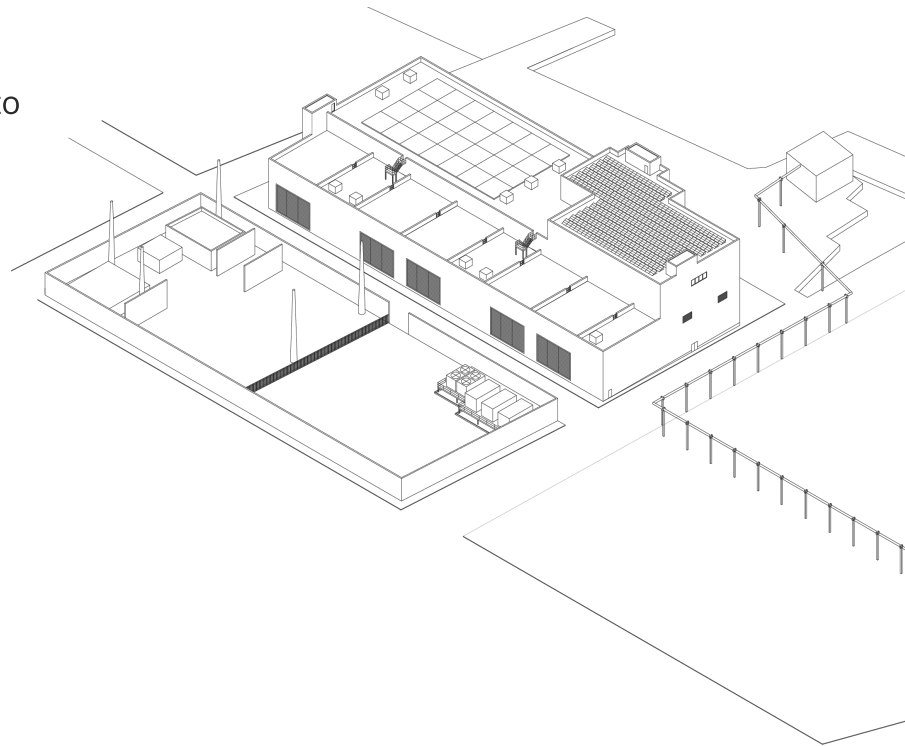

### BENEFITS

- Project is firm and available
- Facility will be ready in 2028 to accept 1st interconnection
- Minimal modification cost to inject up to 6,000 MW
- Provides for multiple Transmission interties

### CHALLENGES

- Feeder routes to substation